

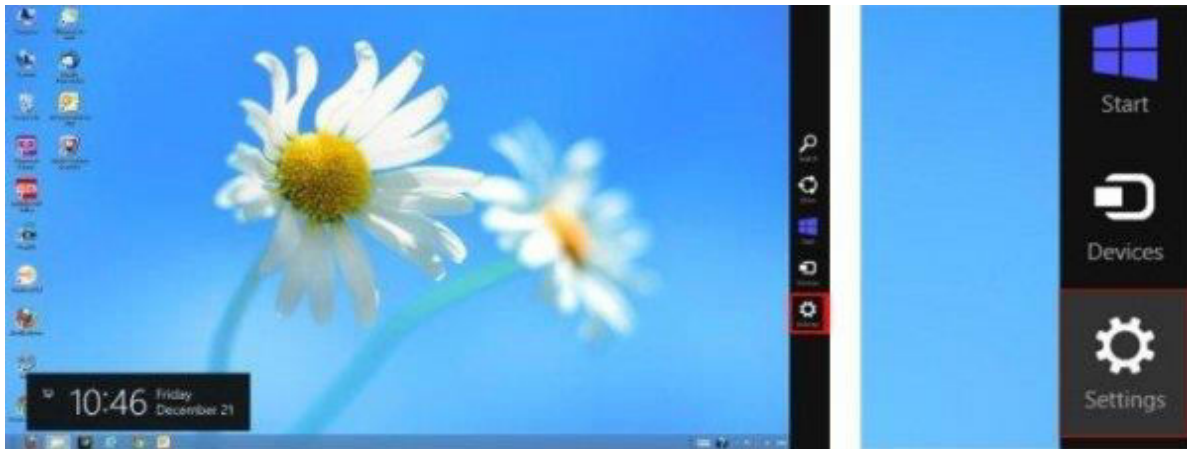

UPUSTVO ZA KREIRANJE I PODEŠAVANJE PPPoE KONEKCIJE – WINDOWS 8

- Sledeće upustvo se odnosi na operativni sistem **Windows 8 i Windows 8.1**.
Usmerite strelicu miša ka gornjem desnom uglu Windows radne površine, pojaviće vam se **Charm Bar**.
Izaberite opciju **Settings**.



- Zatim izaberite opciju **Control Panel**, a potom izaberite opciju **Network and Internet**.

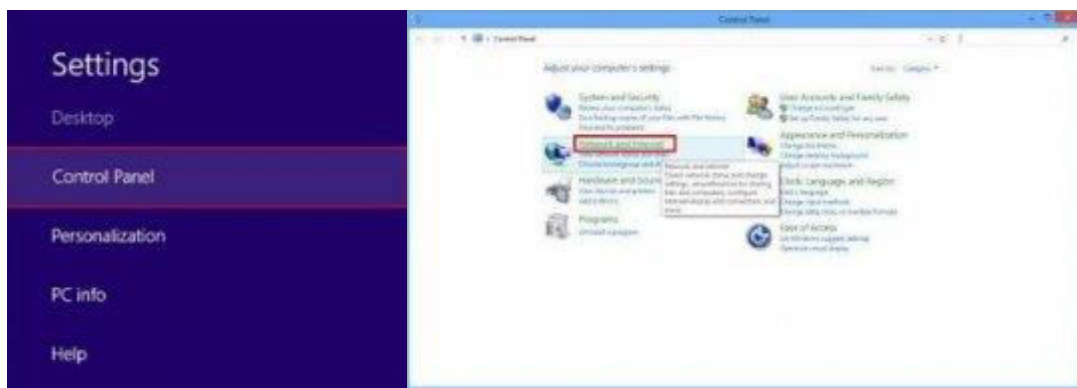

- Izaberite opciju **Network and Sharing Center**.

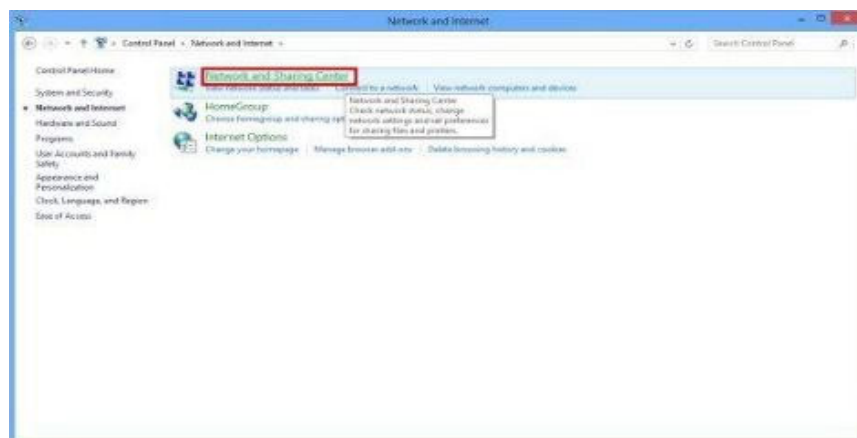

- Izaberite opciju **Set up a new connection or network.**

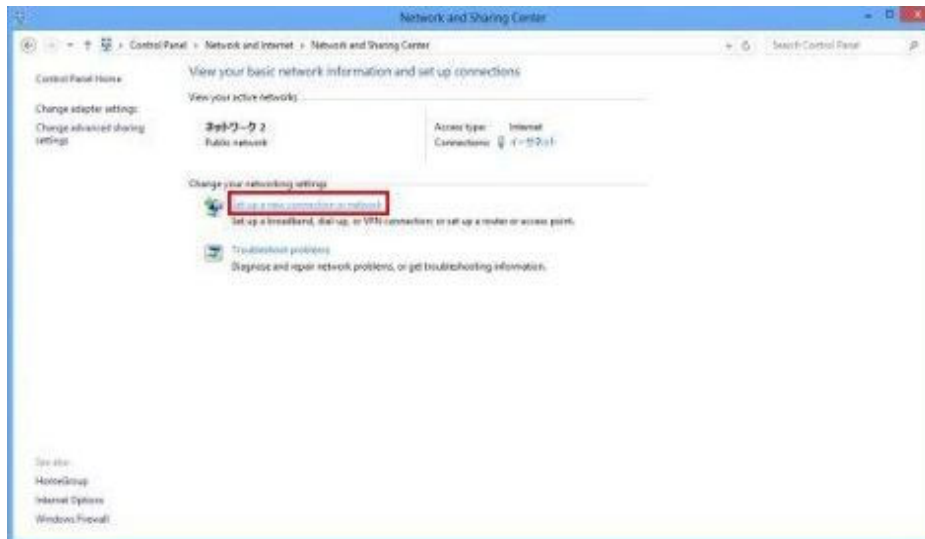

- Izaberite opciju **Connect to the Internet.**



- Izaberite opciju **Broadband (PPPoE)**

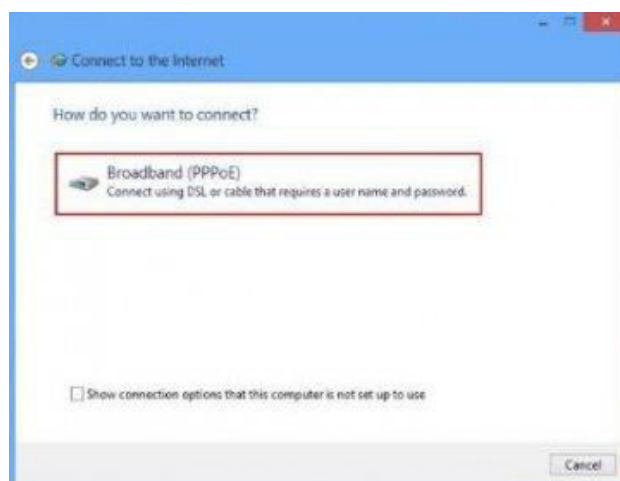

- Nakon toga dolazite do dela gde je potrebno uneti korisničko ime (**user name**) i vašu šifru (**password**) i za naziv konekcije (**Connection name**) možete upisati Sowireless. Poželjno je čekirati opciju **Remember this password**. Pošto je vaša konekcija kreirana kliknite na dugme **Connect**. Kada ste sve uspešno odradili možete koristiti Internet.

Connect to the internet

Type the information from your Internet service provider (ISP)

User name:

Password:

Show characters

Remember this password

Connection name:

Allow other people to use this connection
This option allows anyone with access to this computer to use this connection.

[I don't have an ISP](#)